

Programming and Installation Instructions

CODE LOCK

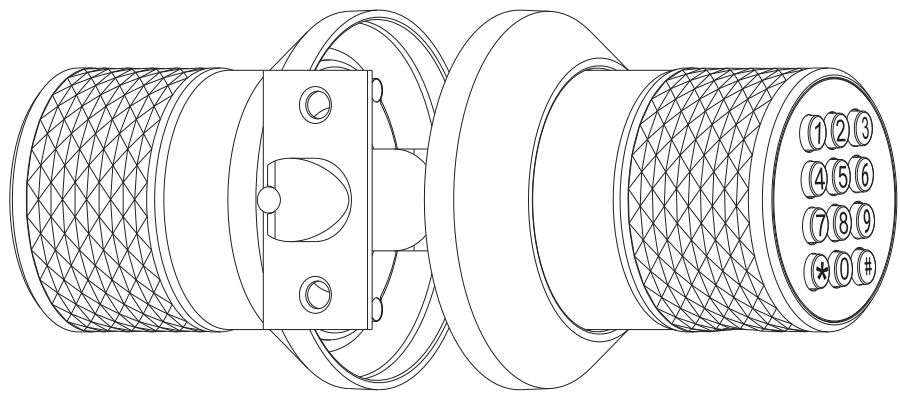

CODE LOCK

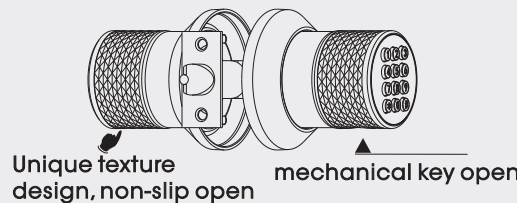

FEATURES

- Waterproof seals protecting electronic components
- Backlit keypad for use in low light
- Up to 10 changeable codes including passage, user and master levels
- Deadlatch assembly with adjustable backset
- DIY installation (instructions included)
- Anti spy code encryption
- Low voltage alarm function, USB emergency power supply
- mechanical key open

ACCESS CODE INSTRUCTIONS

The YL-98 electronic lock is capable of storing up to 10 access codes; 1 Master code, 1 Passage code and 8 User codes. All codes are allocated a starting number or sequence number. The master code is '0', the passage code is '9' and the user codes are '1-8'. The master code must be set up in order to input user codes.

MASTER CODE

The master code is the most important code in the series as it is needed to set up all user codes and the passage code. All codes can be a maximum of 15 digits including the allocated sequence number. The allocated sequence number for the master code is '0', therefore you must ensure this is the first digit of your code and the remainder may be any combination of digits from '0-9'. The manufacturers default code is '0123'. To unlock the lock, enter the code '0123' and press the '#' key. The lock will sound and the green indicator will light. The handle is unlocked while the beep is sounding and will return to the locked position once the beep stops.

CHANGING THE MASTER CODE

Step 1. Enter the default master code '0123' or the current master code, and press the '#' key.

Step 2. Wait until the beeping sound stops but the blue backlight remains on.

Step 3. Enter a new master code that starts with '0' and press the '*' key.

If two beeps are heard the new master code has been saved successfully.

RESETTING THE MASTER CODE

The reset button is located in the small hole of the battery pack and should only be used when master code is lost or forgotten. Press and hold the reset button for 5 seconds until three beeps are heard. The master code will return to the manufacturer default code '0123'.

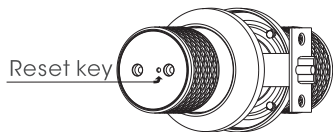

USER CODES AND PASSAGE CODES

The user and passage codes can be any number and combination of '0 - 9' with a maximum of 15 digits. Only the master code can have '0' as the first digit and only the passage code can have '9' as the first digit.

SETTING THE USER CODES AND PASSAGE CODE

Step 1. Enter the current master code and press the '#' key.

Step 2. Wait until the beeping sound stops and the blue backlight remains on.

Step 3. Enter a new user code beginning with that codes sequence number and press the '*' key. E.g. the first user code will begin with '1'.

Once you hear two beeps the first user code has been saved into the lock.

Step 4. Enter the second user code starting with sequence number '2' and press the '*' key.

Once you hear two beeps the second user code has been saved into the lock.

SETTING THE USER CODES AND PASSAGE CODE contd . . .

Repeat these steps until all eight user codes and the passage code have been successfully set.

Note: Each user code must be entered while the blue backlight is on. If light goes out, you must re-enter the master code to unlock the lock again.

CHANGING USER CODES

In addition to the master code, each user code has the ability to change their own code.

Step 1. Enter the user code you want to change and press the '#' key.

Step 2. After the beep stops and before the blue backlight goes off, enter the new user code and press the '*' key. (E.g. If user one is resetting their code, the new code must again begin with '1')

CHANGING USER CODES . . .

Once you hear two beeps the new user code has been saved into the lock.

Note: Door should always be ajar when adding / changing codes.

DELETING A USER CODE

If you want to delete all user codes.

Step 1. Enter the master code and press the '#' key.

Step 2. After the beep stops and before the blue backlight goes off, enter '0' five times and press the '*' key.

Once you hear two beeps all codes will be erased and only the master code will be able to operate the lock.

If you want to delete an individual user code.

Step 1. Enter the master code and press the '#' key.

Step 2. After the beep stops and before the blue backlight goes off, enter '0000' and the sequence number of the code you want to delete and press the '*' key. (E.g. To delete code one - enter '00001') Once you hear several beeps, the user code selected will be erased.

Repeat this procedure for any other user codes you wish to delete.

PASSAGE MODE - ONE DIGIT ACCESS

The YL-98 has the ability to be set to passage mode by entering a passage code.

In passage mode, all users can press any key to open the door without requiring a user code.

How to enter passage mode

Step 1. Enter the passage code (beginning with sequence number '9') then press '#'.

Step 2. After the beep stops and before the blue backlight goes off, press '*' then '#' in quick succession. Once you hear two beeps the lock is in passage mode.

How to cancel passage mode

Step 1. Press any key to activate the lock.

Step 2. After the beep stops and before the blue backlight goes off, press '*' then '#' in quick succession.

Once you hear two beeps passage mode is cancelled.

Mechanical key open

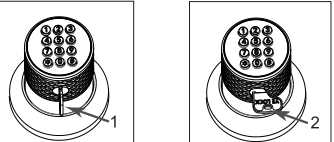

1. Insert key, fib. 1
2. Twist the key 90 degree, fib. 2
3. Turn the knob to open

ENCRYPTION

This function is an added security feature which is aimed at preventing codes being observed while being entered.

Step 1. Enter the first digit of the code you want to enter.

Step 2. Enter any sequence of digits to confuse the observer.

Step 3. Enter the balance of the user code, followed by the '#' key.

Example:

- User code is '83557373'
- Enter the first digit: 8
- Enter any digits to confuse the observer: 564778458
- Enter the balance of the original user code: 3557373 and press '#'

TIP VOICE ON/OFF

long press * key for 5 seconds, tip voice off, long press again * key for 5 seconds tip voice on

BATTERY INFORMATION

The lock requires four 'AA' alkaline batteries which are housed in the internal handle.

The lock has a low battery indicator which when unlocking the door will sound a continuous beep, followed by a single beep.

New batteries should be installed within approximately two weeks.

Expected battery life is approximately 180 days and all time measurements are calculated on twenty uses per day.

If the batteries are completely dead, you can use the emergency backup battery pack (supplied) to power the lock, however ensure that the batteries in the lock are replaced immediately.

LOCK COMPONENTS

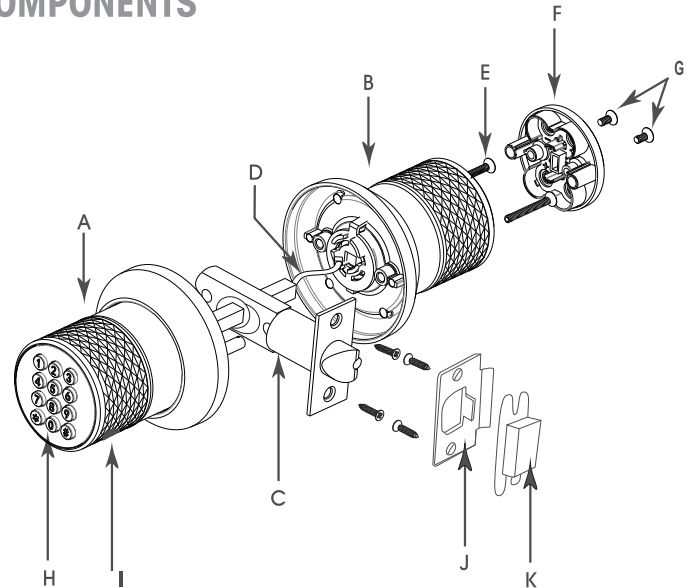

- A : Outside knob
B : Inside knob
C : Latch Assembly
K : Wrought Box
- D : Power cable
E : mounting screw
F : Battery cover
I : Emergency power socket
- G : Mounting screw
H : Keypad
J : Strike Plate

INSTALLATION INSTRUCTIONS

Step 1. Mark Door Using template, mark hole on both sides of door at required backset, then mark latch hole on door edge.

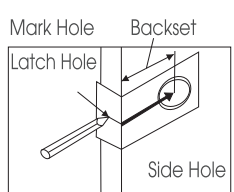

Step 2. Drill Holes Bore a 54mm hole on door face, then drill 25mm hole in door edge to intersect with center of 54mm hole. Note: Drill 54mm hole from both sides of door to stop wood splintering

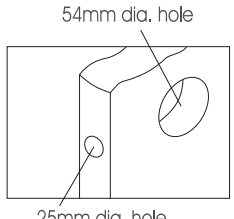

Step 3. Install Latch Insert latch into hole and mark a line around edge of latch plate and remove latch. (Fig. 3a) Chisel approx. 3mm deep or until latch plate sits flush with door edge. (Fig. 3b) Insert latch then drill 2 x 3mm holes for mounting screws and fasten latch. (Fig. 3c)

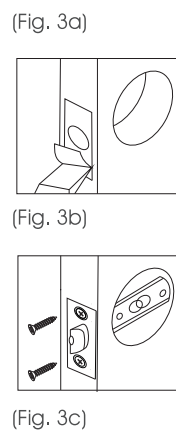

Step 4. Install Strike

Close door and mark horizontal centre of latch on to door frame. Mark vertical line where door edge meets frame and measure in half of door thickness to find vertical centre. (Fig. 4a) Extend both lines until they intersect and drill a 25mm hole to 15mm depth. Position strike plate and mark around edge. Chisel frame to approx 1.5mm depth or until strike sits flush. Drill 2 x 3mm screw holes and fix strike to frame. (Fig. 4b)

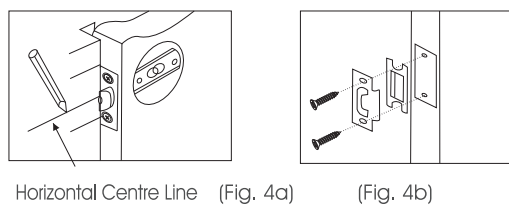

Step 5. Install Outside Knob

Feed the power cable through latch and guide spindle into handle. (Fig. 6a) Screw inside knob to outside knob using mounting screws. (Fig. 6b) Install 4 pieces LR6 / 1.5v / AA alkaline batteries into the battery box, and install the + / - batteries in strict accordance with the arrow as shown in the figure.

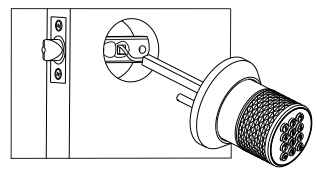

Step 6. Install Inside Knob Feed power cable through hole in knob and guide spindle into handle. (Fig. 6a) Screw inside knob to outside knob using mounting screws. (Fig. 6b) Install 4 pieces LR6 / 1.5v / AA alkaline batteries into the battery box, and install the + / - batteries in strict accordance with the arrow as shown in the figure.

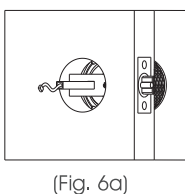

Step 7. Install the battery Install 4 pieces LR6 / 1.5v / AA alkaline batteries into the battery box, and install the + / - batteries in strict accordance with the arrow as shown in the figure. The wrong installing + / - battery will make the product unable to work, and will also lead to destructive malfunction

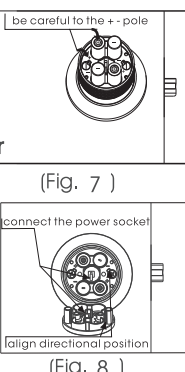

The Installation Instructions for YL-98 Digital Lock

1. Select the lock-tongue between the size of 60mm and 70mm
2. Plug in the power socket according to the installation diagram. The extra power cord must be recycled and kept from crushing.
3. Install 4 AA alkaline batteries and make sure the positive and negative electrodes are placed correctly;
4. Screw down the mounting screw and keep the handle inside and outside flexible.

Routine Troubleshooting for YL-98 Digital Lock

1. De-energized

- (1) Inspect whether the plug falls off or be plugged in oppositely;
- (2) Inspect whether the positive and negative electrodes of the 4 batteries are opposite;
- (3) Inspect whether the wire and power line of the batteries holder are broken.

2. Incapable of unlocking with New Installation and Charging

- (1) Enter the correct password and press '#', then rotate the handle and open the door before the unlocking beeping stops. (Please note the key words: 1. Enter the correct password; 2 Unlock before the beeping stops.)
- (2) Set the password correctly; the management code is combined with 2-15 numbers headed with '0', but the second number can't be '0'; The user code can be a random combination headed with '1' to '9'nd followed by '2' to '15'
- (3) Distinguish the correctness of the password. There will be a beeping of 2.5s if a correct password is entered ended with '#'. If not, that means the password is wrong. Please reset the password. (The password can be reset to the factory defaults as management code of 0123.)

3. Broken Down in a few months after Using

- (1) It must be caused by the use of bad batteries. Good alkaline batteries can work for about 1 year. The issue could be fixed by changing the batteries.
- (2) How to judge the under-voltage of batteries: when continuous beeping (10 times) is heard after the door is unlocked with the correct password, it means the batteries is under-voltage. Please change the batteries in 15 days after the first beeping is heard.

Stick template to door, aligning fold correctly on door edge.

